

## **Earnst Hardware Engineering Pte Ltd**

Established since 1999, Earnst Hardware Engineering Pte Ltd has been growing rapidly to meet the diverse needs for standard industrial fasteners, also the specific needs for non standard/customised parts in hardware and engineering industries.

Earnst Hardware Engineering Pte Ltd not only provides a comprehensive range of high quality products for our distinguished clientele, we also give the best of our services complemented with our commitment to response promptly, ensure on-time deliveries and effective after sales services.

**DIN 84**

Slotted Cheese Head Screws

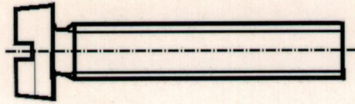
**DIN 85**

Slotted Pan Head Screws

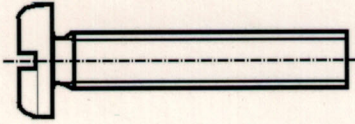
**DIN 444B**

Eye Bolts

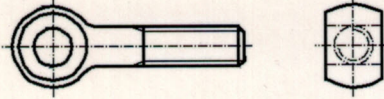
**DIN 571**

Hexagon Head Wood Screws

**DIN 580**

Lifting Eye Bolts

**DIN 603**

Mushroom Head Square Neck Bolts

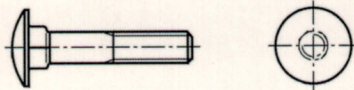
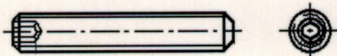
**DIN 913****DIN 914**

Hexagon Socket Set Screws with Cone Point

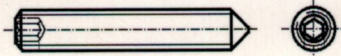
**DIN 915**

Hexagon Socket Set Screws with Dog Point

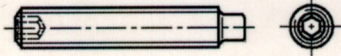
**DIN 916**

Hexagon Socket Set Screws with Cup Point

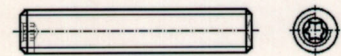
**DIN 931/933**

Hexagon Head Bolts

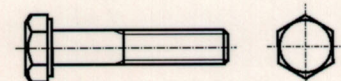
**DIN 938/939**

Studs Metal End 1d / 1,25d

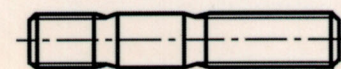
**DIN 965**

Cross Recessed Countersunk (Flat) Head Screws

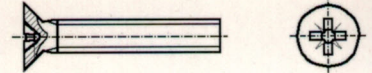
**DIN 975**

Threaded Rods

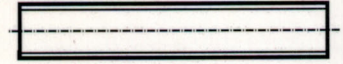
**DIN 6921**

Hexagon Flange Bolts

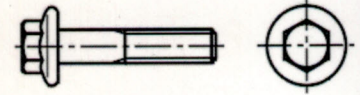
**DIN 7504**

Blind Rivets Self-drilling Hexagon Head Screws with Collar

**DIN 7981 C/F**

Crossed Recessed Pan Head Tapping Screws

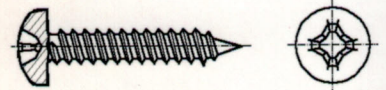
**DIN 7982 C**

Crossed Recessed Countersunk Head Tapping Screws

**DIN 7985**

Philip Cross Recessed Pan Head Machine Screw

**DIN 7991**

Hexagon Socket Countersunk Head Screws

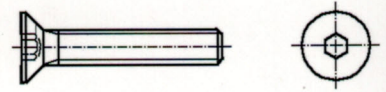
**ISO 14583**

Pan Torx Screw

**ISO 7379**

Hexagon Socket Head Shoulder Screws

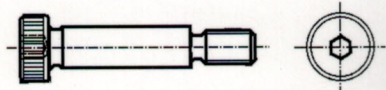
**ISO 7380**

Hexagon Socket Button Head Cap Screws

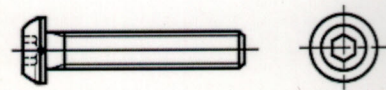

Cross Recessed Dry Wall Screws

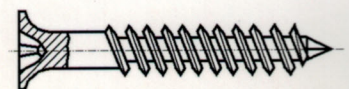

**DIN 439**

Hexagon Thin Nuts

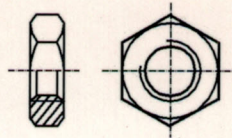

**DIN 562**

Square Nut

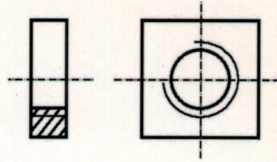

**DIN 582**

Lifting Eye Nuts

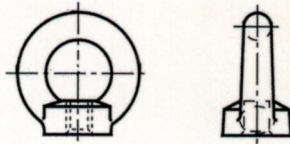

**DIN 929**

Hexagon Weld Nuts

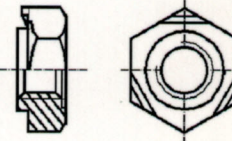

**DIN 934**

Hexagon Nuts

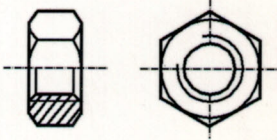

**DIN 935**

Castle Nuts

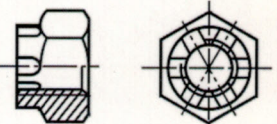

**DIN 982/985**

Prevailing Tongue Type Hexagon Nuts with Non-metallic Insert

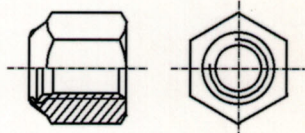

**DIN 1587**

Hexagon Domed Cap Nuts

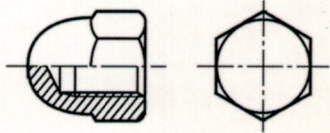

**DIN 6923**

Hexagon Flange Nuts

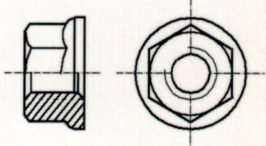

**DIN 6334**

Hexagon Connection Nuts

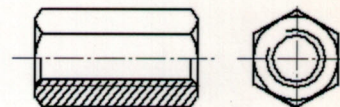

**DIN 934**

Wing Nuts

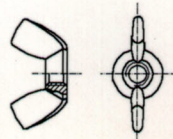

Blind Rivets Nuts with Cylindrical Head

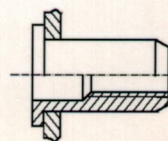

**DIN 6797 A**

Toothed Lock Washers, External Teeth

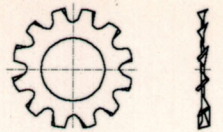

**DIN 6797 J**

Toothed Lock Washers, Internal Teeth

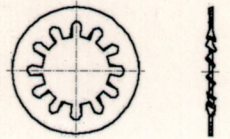

**DIN 6798 A**

Serrated Lock Washers, External Teeth

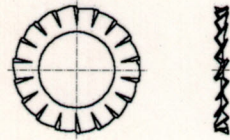

**DIN 6798 J**

Plain Serrated Lock Washers, Internal Teeth

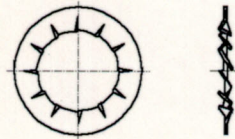

**DIN 6917**

Square Taper Washers

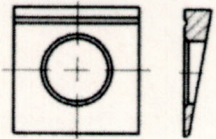

Safety Washers

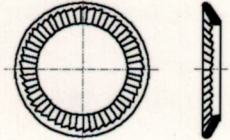

**DIN 93**

Tab Washers with Long Tab

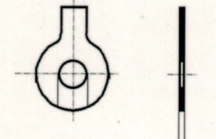

**DIN 463**

Tab Washers with Long Tab and Wing

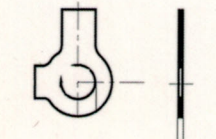

**DIN 125**

Plain Washers

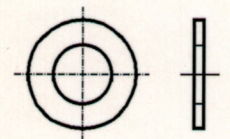

**DIN 127 B**

Spring Lock Washers with Square Ends



**DIN 433**

Plain Washers for Cheese Head Screws



**DIN 436**

Square Washers specially for Wood Constructions

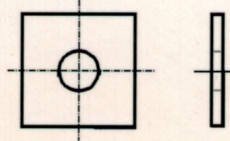

**DIN 1 B**

Taper Pins

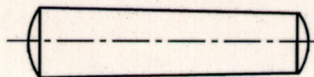

**DIN 7**

Parallel Pins,  
Dowel Pins

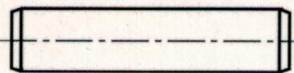

**DIN 94**

Split Pins

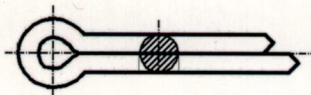

**DIN 6799**

Retaining Washer for  
Shafts



**DIN 471**

Retaining Rings  
for Shafts

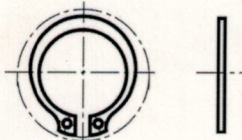

**DIN 472**

Retaining Rings  
for Bores

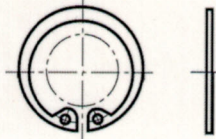

**DIN 8140 A/B**

Thread Inserts

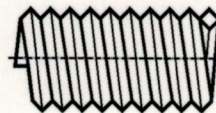

**DIN 11024**

R Pin

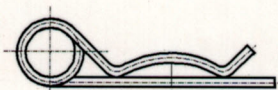

**DIN 660**

Round Head Rivets

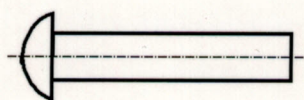

**DIN 661**

Countersunk Head  
Rivets

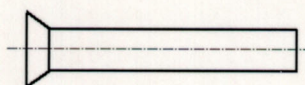

**DIN 741**

Wire Rope Clips

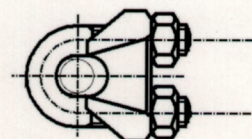

**DIN 906**

Hexagon Socket  
Pipe Plugs, Tapered  
Thread

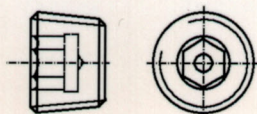

**DIN 1480**

Turnbuckles

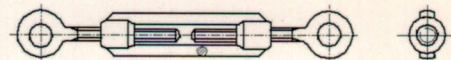

**DIN 1481**

Spring-type  
Straight Pins  
Slotted Type

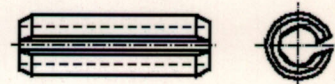

**DIN 7337 A/B**

Blind Rivets

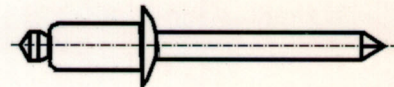

**DIN 82101 A**

Dee (Chain) Shackles  
Type A

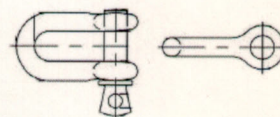

**Expanding Bolts**

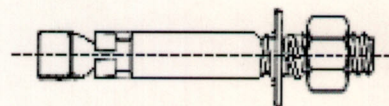

**Expanding Plugs**

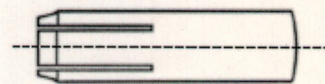

**Safety Bolts**

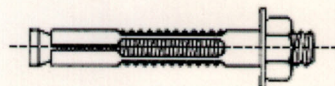

**Drive Screws**

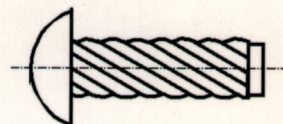

**U-bolts**

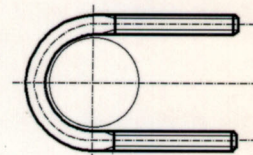

**Fabrication**

Acute J bolt

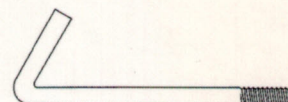

**Fabrication**

Square U bolt

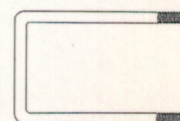

**Fabrication**

Eye bolt

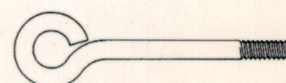

### Standard Fasteners

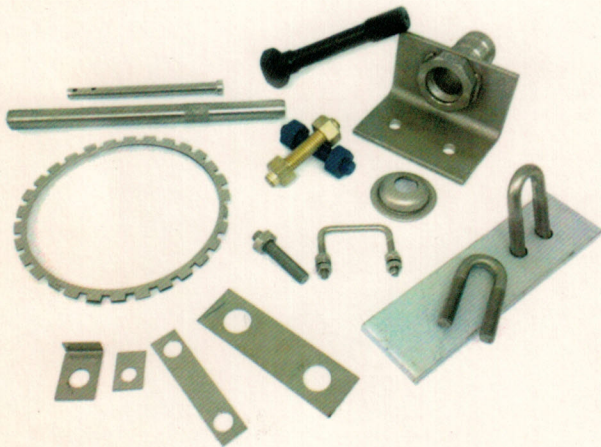

### Fabrication Works

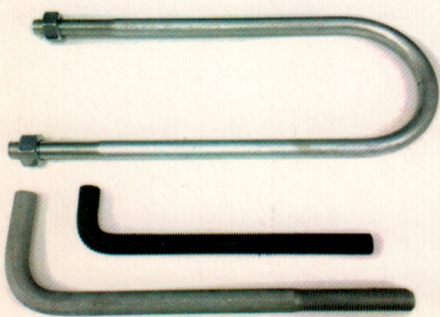

### Angle Bolts

### Material Grade

- . Brass
- . Stainless Steel 304/ 316
- . Alloy Steel 4.8/8.8/10.9/12.9
- . ASTM A193-B7 / ASTM A194-2H
- . ASTM A325
- . ASTM A307

### Coatings

- . Zinc Plating
- . Cadmium Plating
- . Hot Dipped Galvanized
- . Fluorocarbon Coating (PTFE)



## Earnst Hardware Engineering Pte Ltd

Block 13 Pioneer Road North #01-75  
Singapore (628463)

Tel: (65) 6266 4484  
Fax: (65) 6266 4494  
Email: [sales@earnst-hne.com](mailto:sales@earnst-hne.com)  
Website: [www.earnst-hne.com](http://www.earnst-hne.com)

Fabrications and machining works available  
Special Enquiries Welcome

